

SEÇÃO TRANSVERSAL 237
Esc 1:1000

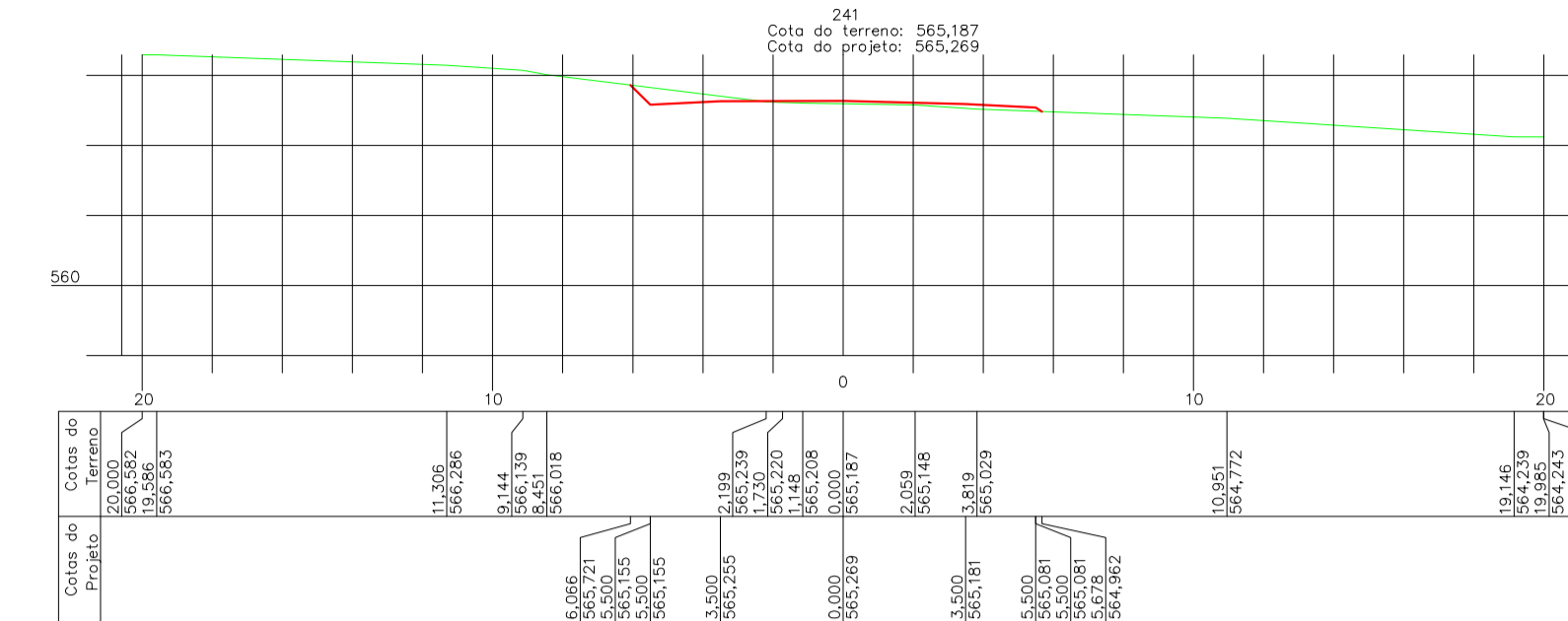

SEÇÃO TRANSVERSAL 241
Esc 1:1000

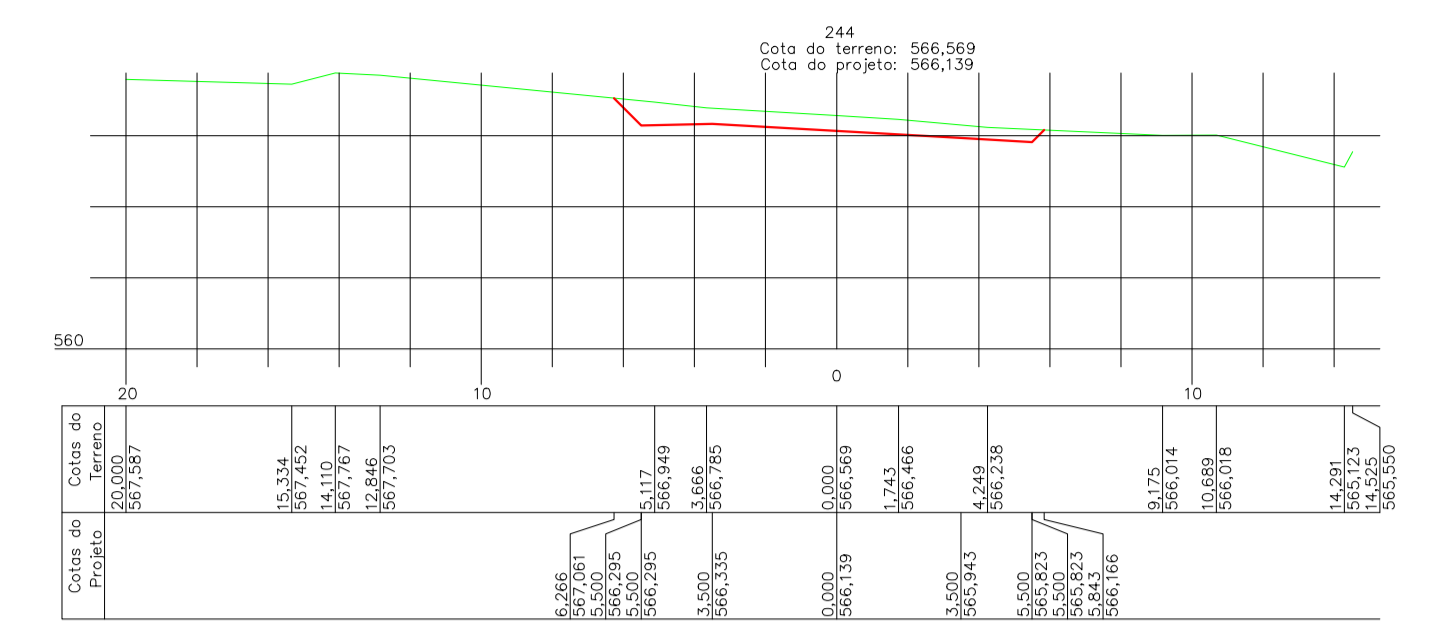

SEÇÃO TRANSVERSAL 244
Esc 1:1000

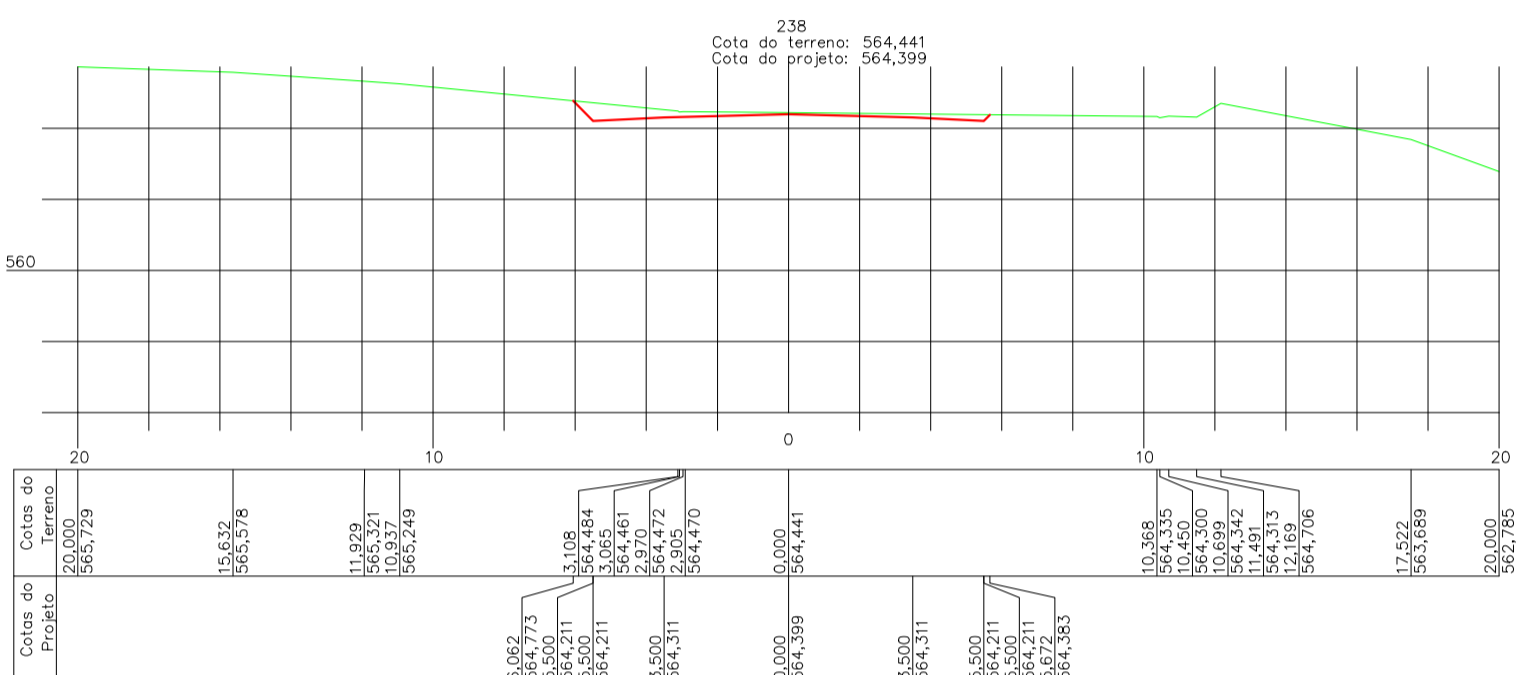

SEÇÃO TRANSVERSAL 238
Esc 1:1000

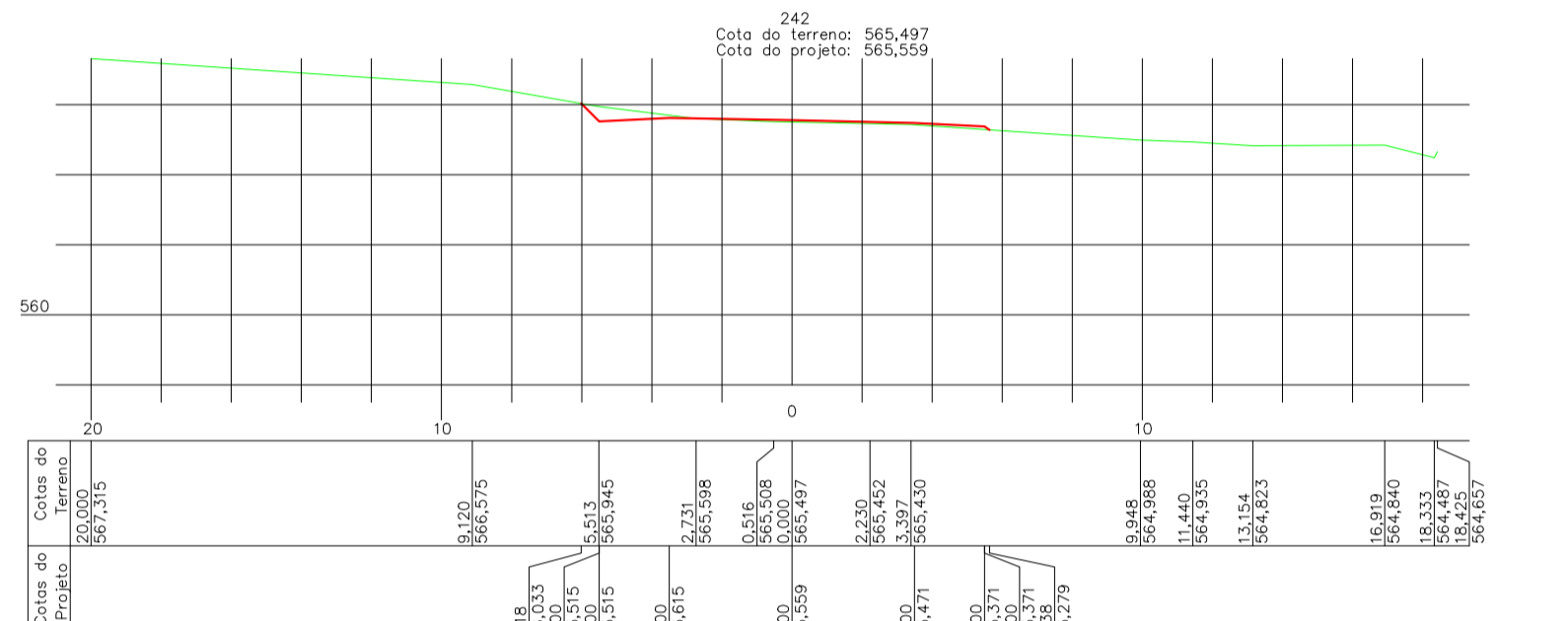

SEÇÃO TRANSVERSAL 242
Esc 1:1000

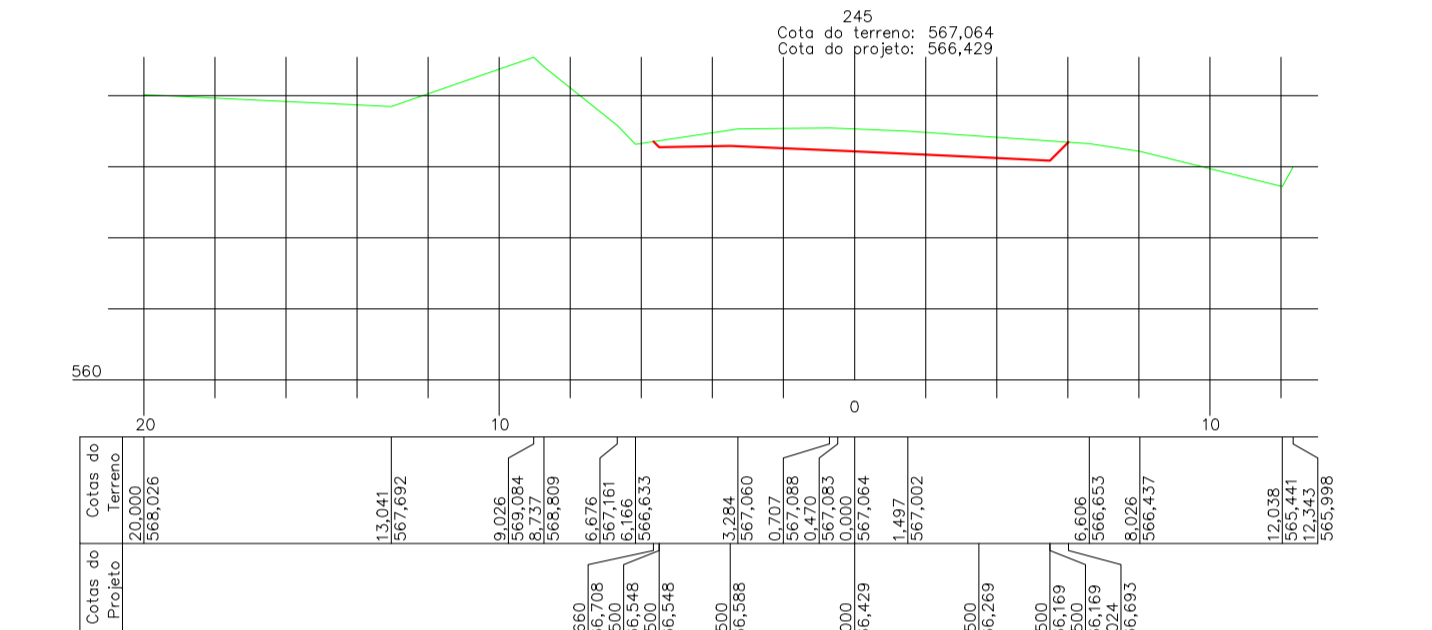

SEÇÃO TRANSVERSAL 245
Esc 1:1000

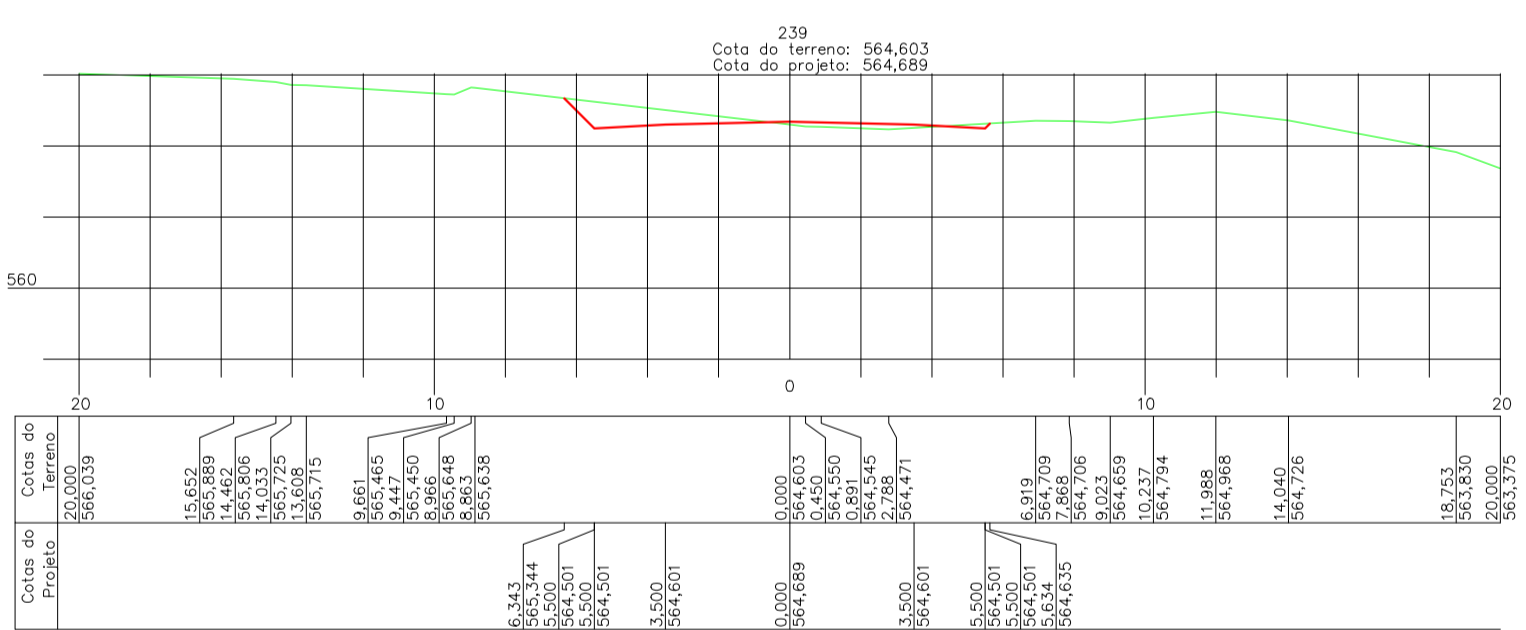

SEÇÃO TRANSVERSAL 239
Esc 1:1000

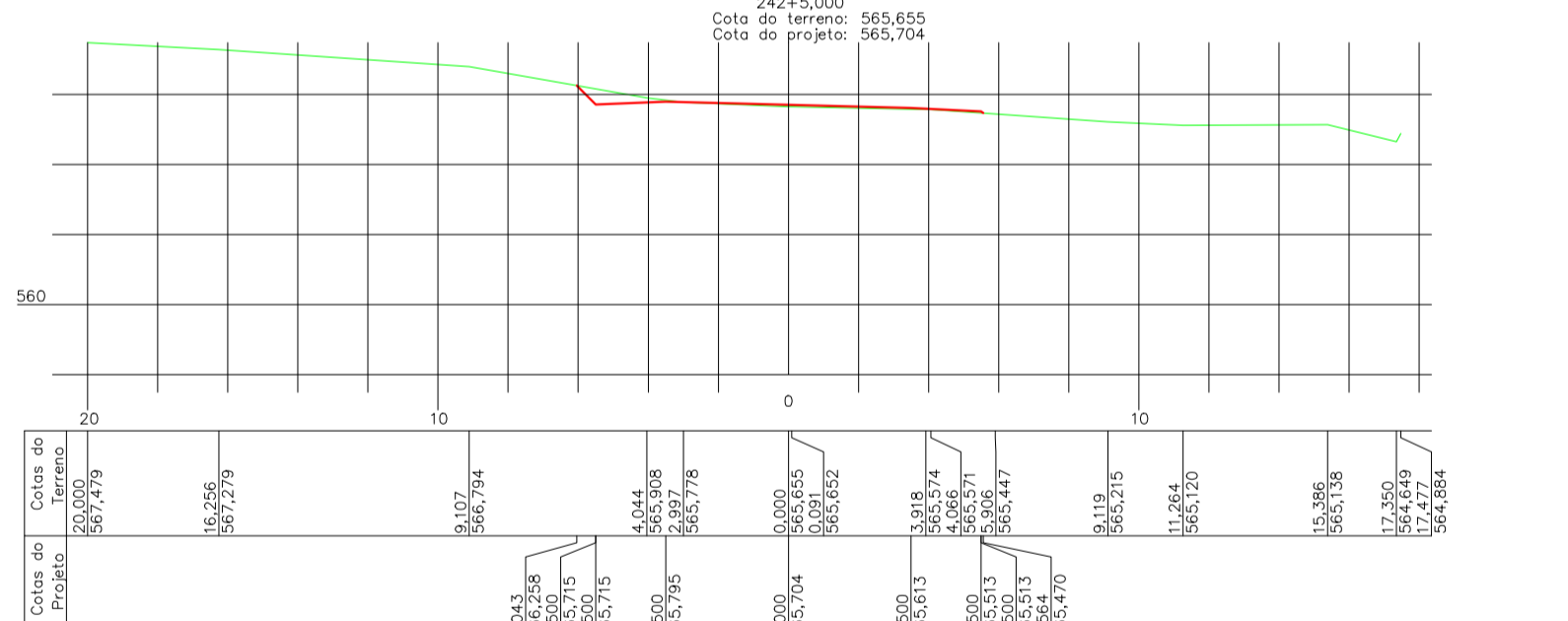

SEÇÃO TRANSVERSAL 242+5.000
Esc 1:1000

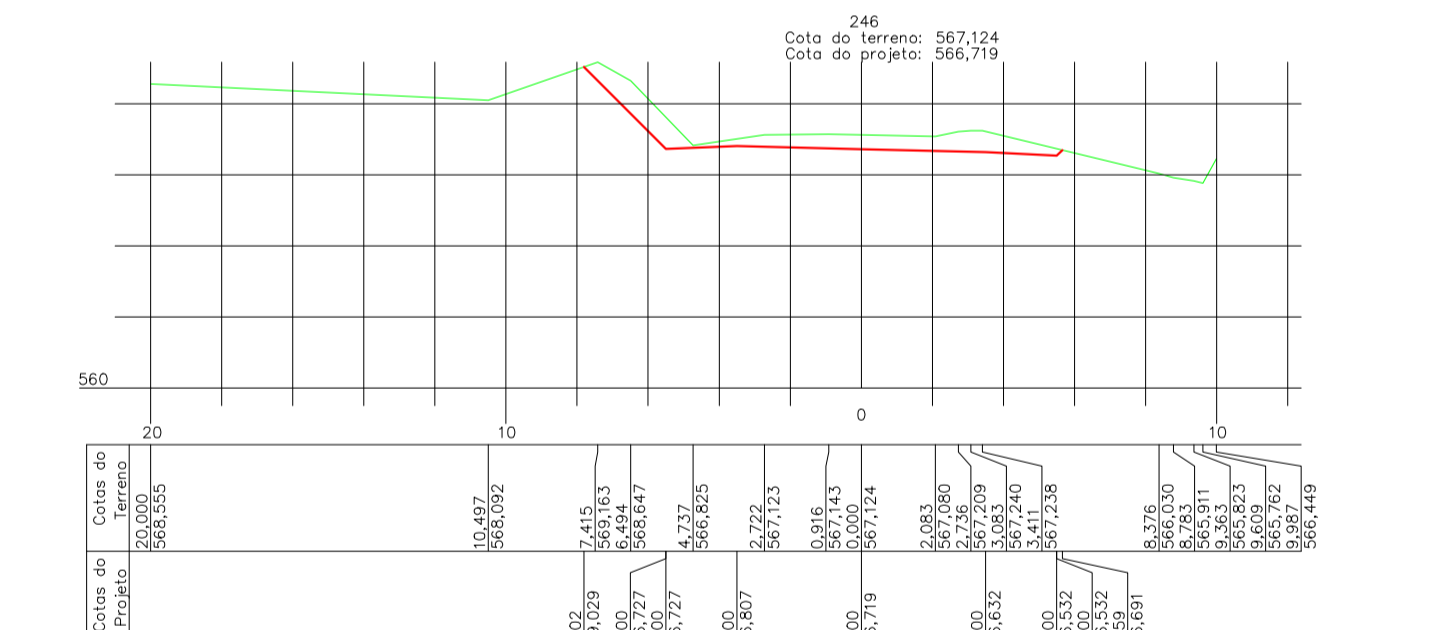

SEÇÃO TRANSVERSAL 246
Esc 1:1000

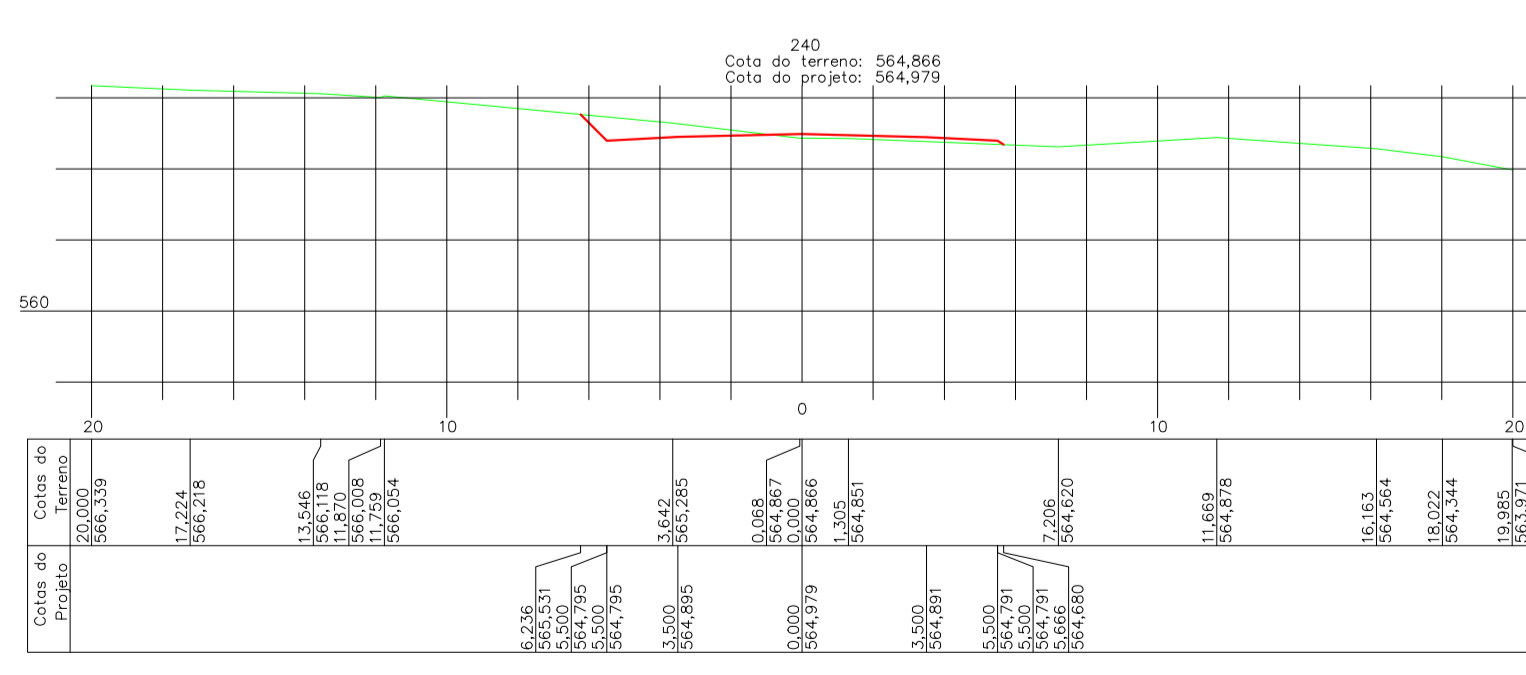

SEÇÃO TRANSVERSAL 240
Esc 1:1000

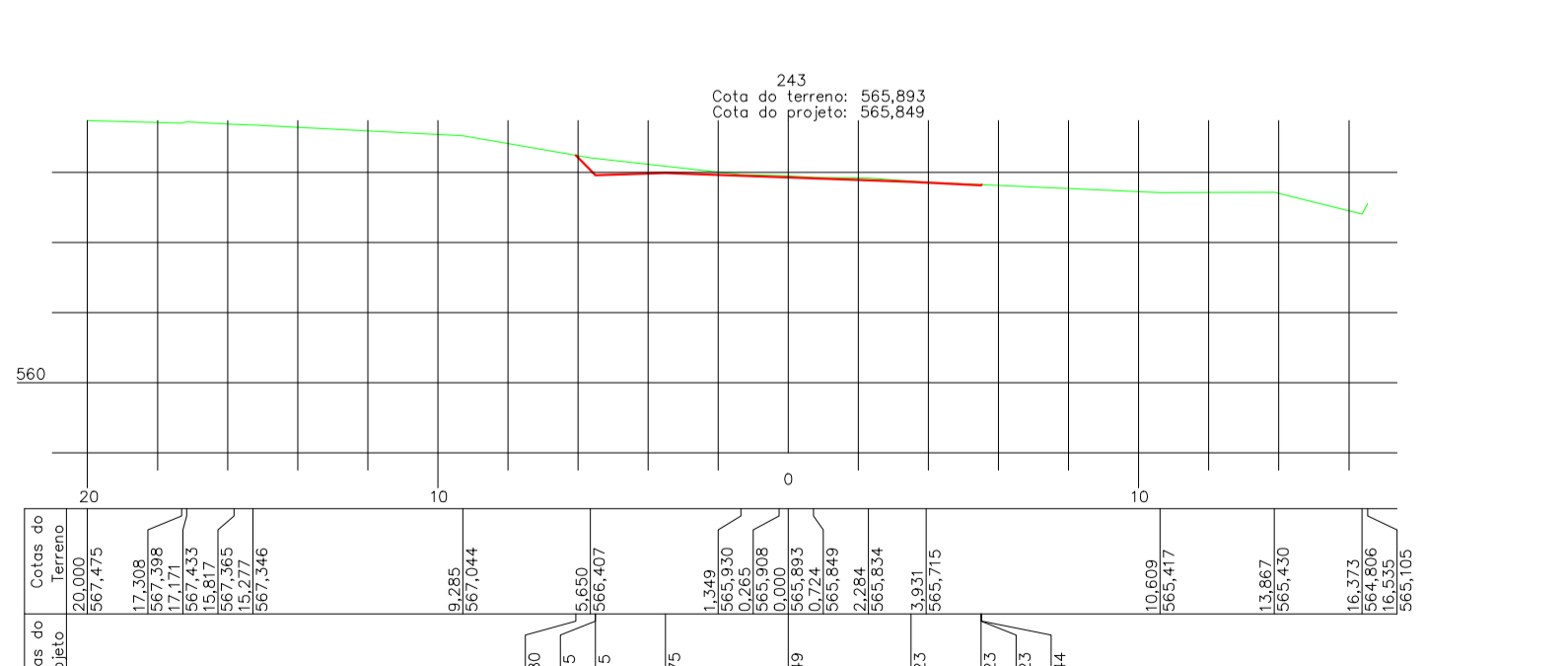

SEÇÃO TRANSVERSAL 243
Esc 1:1000

 <p>PREFEITURA MUNICIPAL DE MARAVILHA - SC</p>	TÍTULO: PROJETO BÁSICO DE PAVIMENTAÇÃO ASFÁLTICA	
	PROPRIETÁRIO: MUNICÍPIO DE MARAVILHA - SC	LOCAL: La Primavera
	REFERÊNCIA: SEÇÃO TRANSVERSAL - TRECHO II	DATA: AGOSTO /2017
	ESCALA: Indicado	FESENHO:
RESP. TÉCNICO: CREA-SC: 041.928/P	FECHA:	10
DESENHO: JORGE LUIZ OLIVEIRA Engenheiro Civil		

Fone/Fax (48) 3664 0044
Avenida Epitácio da Cunha, 60 - Centro
Maravilha-SC